



Hoist | Electrical Chain hoist & Combinations I



Features:

- Capacities 500 - 1.000 - 2.000 Kg
- Available as Stationary hoist as well as complete hoist/trolley unit combined with HD3C Trolley
- Optimized solution, high quality standards combined in one combopack
- Compact design, very low in weight
- Silent design by gearboxes with helical geared wheels, smooth and silent chain guiding
- Including chain container
- Integrated slipping clutch, against overload
- Push Trolleys and Geared trolleys adjustable in range as presented in the table

- Electric Trolleys with double speed motor 5/20 m/min, excl. travel limit switches
- Motors IP55, ISO F, 400 V, 3 Ph 50 Hz
- Control voltage 48 V- with control push button pendant, suspended from hoist
- Temperature class -10°C....+40°C

Optional:

- Alternative supply voltage
- Power supply to unit by cabling on Festoon system
- Power supply to unit by multi conductor system
- Terminal box for connection to power supply point
- Main switch at the end of power supply line

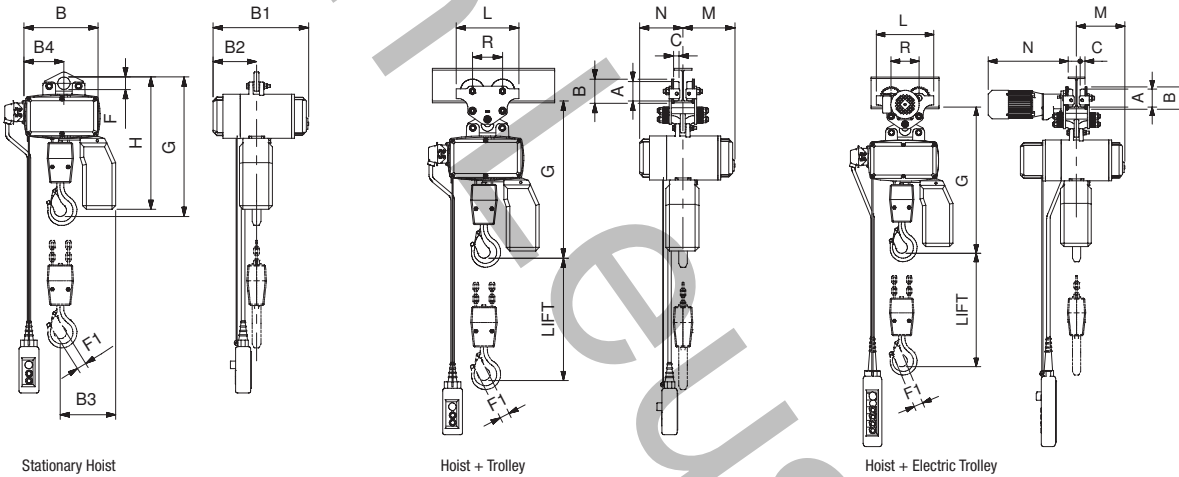

Hoist / Electric driven chain hoists & combinations type I (Art. group 89101)																																		
Hoist							Hoist + Trolley											Hoist + Electric Trolley																
Capacity Kg.	No. Of Falls	Lifting Speed m/min	FEM 9,511 ISO 4301	Lifting Height Standard	Art. No. 89101..	Dimensions Stationary hoist								Trolley Type	Beamwidth min-max mm	Dimensions								Trolley Type	Beamwidth min-max mm	Dimensions								
						B	B1	B2	B3	B4	G	F	F1			H	G	A	B	C	N	M	R			L	G	A	B	C	N	M	R	L
500	2/1	4,0 / 1,0	1Am	3 mtrs	..05001	280	327	165	183	140	463	36	26	415	11 KN	55-102	523	60	75	18	165	162	99	190	22 KN	74-127	538	80	100	22	320	162	123	255
						105-152	127-180																											
						156-203	190-243																											
						207-254	254-305																											
1.000	2/1	4,0 / 1,0	1Am	3 mtrs	..10001	280	327	165	208	140	463	36	32	415	11 KN	55-102	523	60	75	18	165	162	99	190	22 KN	74-127	538	80	100	22	320	162	123	255
						105-152	127-180																											
						156-203	190-243																											
						207-254	254-305																											
2.000	2/1	5,0 / 1,25	1Am	3 mtrs	..20001	310	375	196	271	166	570	52	38	512	22 KN	74-127	645	80	100	22	196	179	123	255	22 KN	74-127	645	80	100	22	320	179	123	255
						105-152	127-180																											
						156-203	190-243																											
						207-254	254-305																											

Hoist					Hoist Prices €				Hoist + Trolley prices €							Hoist + Trolley prices €						
Capacity Kg.	No. Of Falls	Lifting Speed m/min	FEM 9,511 ISO 4301	Lifting Height Standard	Art. No. 89101..	Basic Hoist	Top Hook	6 mtrs Lift	Limit switch Hoisting	Trolley Type	Beamwidth min-max mm	Basic Unit Push	Basic Unit Geared	6 mtrs Lift	Towing arm power	Trolley Type	Beamwidth min-max mm	Basic Unit Electric	6 mtrs Lift	Travel Limit Switches	Towing arm power	
500	2/1	4,0 / 1,0	1Am	3 mtrs	..05001					11 KN	55-102					22 KN	74-127					
											105-152						127-180					
											156-203						190-243					
											207-254						254-305					
1.000	2/1	4,0 / 1,0	1Am	3 mtrs	..10001					11 KN	55-102					22 KN	74-127					
											105-152						127-180					
											156-203						190-243					
											207-254						254-305					
2.000	2/1	5,0 / 1,25	1Am	3 mtrs	..20001					22 KN	74-127					22 KN	74-127					
											105-152						127-180					
											156-203						190-243					
											207-254						254-305					